

## FEET & BUMPERS

Plastic/Rubber- Like

Looking for a foot or bumper?

On the following screens are the wide variety of standard injection molded plastic feet and bumpers offered by [Komtech](#). Our many stock sizes and styles are made from Polyethylene or our amazing new rubber-like Polyastomer® formulations. Polyastomer feet and bumpers are designed to replace old-fashioned rubber parts with better properties and 30% lower prices.

If none of our stock parts meet your needs, [Fax](#), [Mail](#) or [E-mail](#) the details of your application to us and we will quickly provide you with our design input and quotation.

Komtech USA Inc  
106 North Park Drive  
Anderson, SC 29625  
Office - (864) 760-1400  
Fax - (864) 328-9670

[sales@komtechusa.com](mailto:sales@komtechusa.com)





If you cannot locate a stock bumper that will fit your application. Challenge us for the solution



### TYPE I: RECESSED ROUND

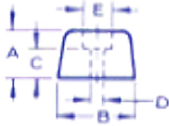

[sales@komtechusa.com](mailto:sales@komtechusa.com)

PART NO.	A	B	C	D	E	SCREW* SIZE	PLASTIC MATERIAL
<b>TYPE I</b>							
OO75	.22 (5.6)	.39 (9.9)	.14 (3.5)	.13 (3.3)	.30 (7.6)	4	Polylastomer®
OO70	.20 (5.1)	.89 (22.6)	.11 (2.8)	.16 (4.1)	.50 (12.7)	6	Polylastomer®
O772	.26 (6.6)	.50 (12.7)	.10 (2.5)	.13 (3.3)	.25 (6.3)	5	Polyethylene
O420	.25 (6.3)	.50 (12.7)	.12 (3.0)	.12 (3.0)	.27 (6.8)	5	Polylastomer®
O421	.25 (6.3)	.50 (12.7)	.10 (2.5)	.15 (3.8)	.28 (7.1)	6	Polylastomer®
O422	.28 (7.1)	.75 (19.0)	.16 (4.0)	.13 (3.3)	.25 (6.3)	4	Polylastomer®
O425	.28 (7.1)	.75 (19.0)	.16 (4.0)	.17 (4.3)	.38 (9.6)	8	Polylastomer®
O447	.31 (7.9)	1.00(25.4)	.13 (3.3)	.18 (4.6)	.60 (15.2)	8	Polylastomer®
O943	.38 (9.6)	.77 (19.5)	.25 (6.3)	.16 (4.0)	.38 (9.6)	6	Polyethylene
O426	.41 (10.4)	.74 (18.8)	.17 (4.3)	.16 (4.0)	.31 (7.9)	6	Polylastomer®
O427	.41 (10.4)	.75 (19.0)	.31 (7.9)	.09 (2.3)	.33 (8.4)	2	Polylastomer®
O448	.42 (10.7)	1.02 (25.9)	.16 (4.0)	.17 (4.3)	.58 (14.7)	8	Polylastomer®
O423	.44 (11.2)	.63 (16.0)	.25 (6.3)	.16 (4.0)	.33 (8.4)	7	Polylastomer®

PART NO.	A	B	C	D	E	SCREW* SIZE	PLASTIC MATERIAL
O965	.50 (12.7)	.88 (22.3)	.35 (8.9)	.19 (4.8)	.38 (9.6)	8	Polyethylene
O966	.50 (12.7)	.88 (22.3)	.35 (8.9)	.16 (4.0)	.38 (9.6)	6	Polyethylene
O449	.56 (14.2)	1.00 (25.4)	.31 (7.9)	.17 (4.3)	.53 (13.5)	8	Polylastomer®
O428	.63 (16.0)	.63 (16.0)	.31 (7.9)	.17 (4.3)	.31 (7.9)	7	Polylastomer®
O429	.63 (16.0)	.63 (16.0)	.31 (7.9)	.19 (4.8)	.38 (9.6)	8	Polylastomer®
O962	.63 (16.0)	.88 (22.3)	.22 (5.6)	.19 (4.8)	.39 (9.9)	8	Polyethylene
O944	.64 (16.2)	1.03 (26.1)	.33 (8.4)	.20 (5.1)	.53 (13.5)	10	Polyethylene
O430	.75 (19.0)	.63 (16.0)	.52 (13.2)	.16 (4.1)	.31 (7.9)	6	Polylastomer®
O946	.75 (19.0)	1.13 (28.7)	.31 (7.9)	.20 (5.1)	.53 (13.5)	10	Polyethylene
O450	.78 (19.8)	1.00 (25.4)	.33 (8.4)	.17 (4.3)	.53 (13.5)	8	Polylastomer®
O972	.85 (21.6)	1.13 (28.7)	.32 (8.1)	.20 (5.1)	.55 (14.0)	8	Polyethylene
O451	1.00 (25.4)	1.00 (25.4)	.55 (14.0)	.17 (4.3)	.55 (14.0)	7	Polylastomer®
O967	1.00 (25.4)	1.13 (28.7)	.54 (13.7)	.25 (6.3)	.47 (11.9)	12	Polyethylene
O947	1.00 (25.4)	2.00 (50.8)	.40 (10.2)	.25 (6.3)	.50 (12.7)	12	Polyethylene
O970	1.55 (39.4)	1.14 (28.9)	.55 (14.0)	.25 (6.3)	.49 (12.4)	12	Polyethylene